

NIB

***Case Hardened Tapped
Or Threaded Shafts
Ready-To-Ship***

*Our most requested diameters and pre-cut lengths
are now also available, off-the-shelf, with
ends already precisely machined.*

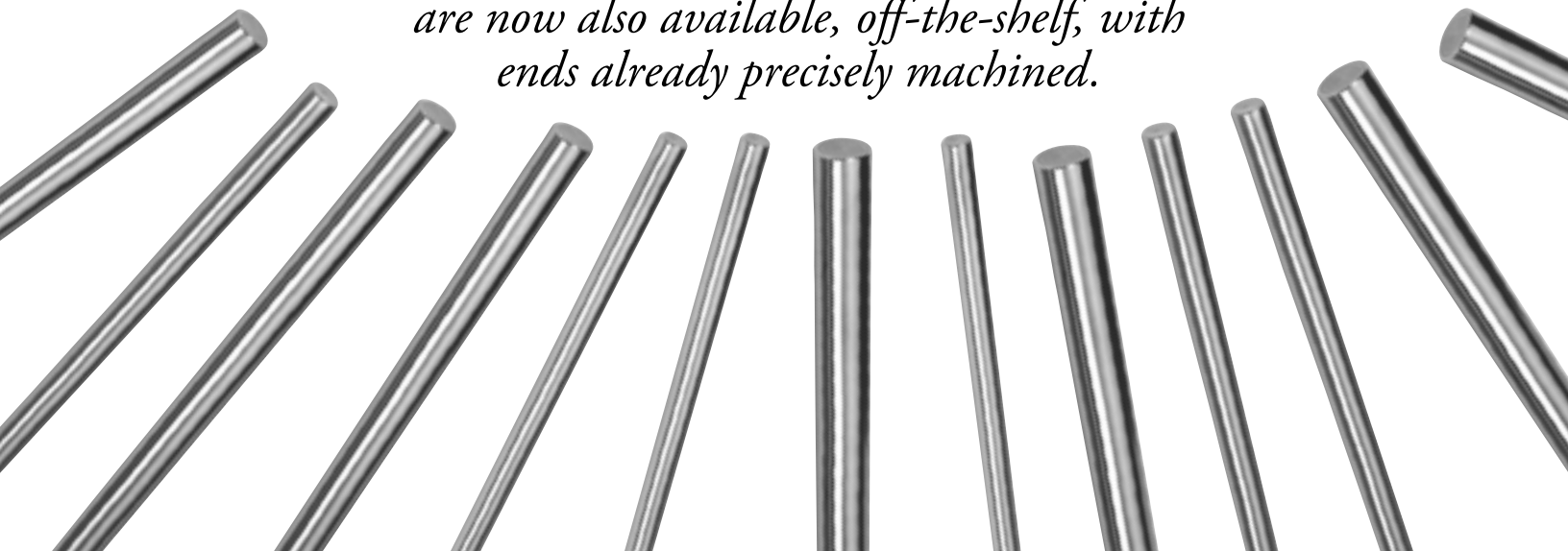

Format Tapped Shafts

Tapped End Shaft Measurements Legend

FS102 (SINGLE END TAPPED) Example: **SFW16x12-FS102**

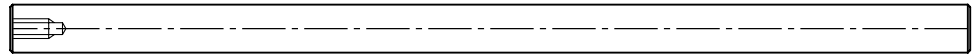

FS103 (BOTH ENDS TAPPED) Example: **SFWS12-24-FS103**

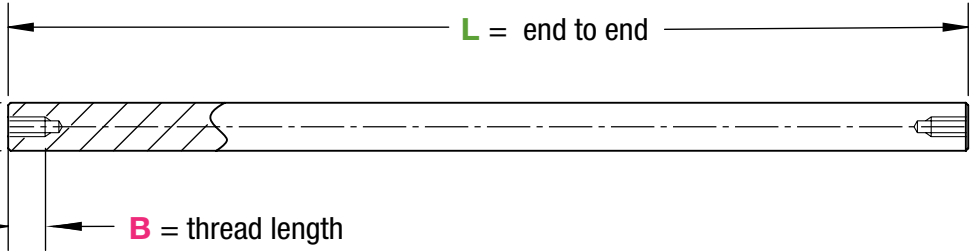

ϕD
= diameter
g6
M =
thread
size

B = thread length

How To Order Shafts

Ordering by part number code makes it unnecessary to specify all the dimensions listed in the tables of specifications associated with each product. All associated dimensions will be indicated by the code.

All you have to do to order is specify:

A. PART CODE

The first letters in the table that symbolize the product series. They also specify whether it is an inch or metric series.

B. DIAMETER CODE

A single code number corresponds to the nominal shaft diameter for all shaft products. For example, Code **4** is 1/4 inch; diameter Code **16** is 1 inch.

C. X LENGTH or TRAVEL

Indicate the length of support shafts.

D. SHAFT MODIFICATION

There are only four symbols: FS102 for one-end tapped; FS103 for both ends tapped; FS115 for one-end threaded; FS116 for both ends threaded. For any other questions...

For Ordering Assistance
Call 1-800-521-2045

Shaft Size Code	OD (D)	Tap Size (M)	Tap Depth (B)	FS102 - Shaft One-End Tapped FS103 - Shaft Both Ends Tapped (L) Available Lengths							
				6"	8"	9"	10"	12"	18"	24"	36"
4	1/4"	5-40	0.250"	●	●	★	★	●	●	●	★
6	3/8"	8-32	0.330"	◆	●	●	●	◆	◆	◆	◆
8	1/2"	1/4-20	0.500"	◆	●	◆	●	◆	◆	◆	◆
10	5/8"	1/4-20	0.500"	◆	●	◆	●	◆	◆	◆	◆
12	3/4"	5/16-18	0.625"	◆	●	◆	●	◆	◆	◆	◆
16	1"	3/8-16	0.750"	◆	●	◆	●	◆	◆	◆	◆
20	1 1/4"	1/2-13	1.000"	◆	●	◆	●	◆	◆	◆	◆
24	1 1/2"	5/8-11	1.250"	◆	★	★	★	◆	◆	◆	◆

Explanation Of Tapped Shaft (Part Number) Symbols

A	B	x	C	-	D
Series Materials	Shaft Size Code (D)		Overall Length (L)		Shaft Modifications
SFW Carbon Steel					FS102 -Single End Tapped
SFWS Stainless Steel					FS103 -Both Ends Tapped

- Available in Carbon Steel Only
- ◆ Available in both Carbon Steel and Stainless Steel
- ★ Available by Quote Only

Example:
Carbon Steel slide shaft that has a 1" diameter, is 12" long with one end tapped. Order **SFW16x12-FS102**

Stainless Steel slide shaft that has a 3/4" diameter, is 24" long with both ends tapped. Order **SFWS12x24-FS103**

Format Threaded Shafts

Threaded End Shaft Measurements Legend

FS115 (SINGLE END THREADED) Example: SFW16x13.25-FS115

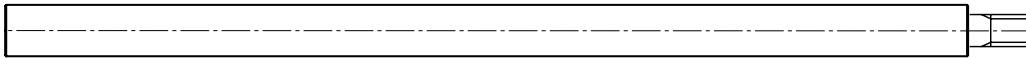

FS116 (BOTH ENDS THREADED) Example: SFW8x24.25-FS116

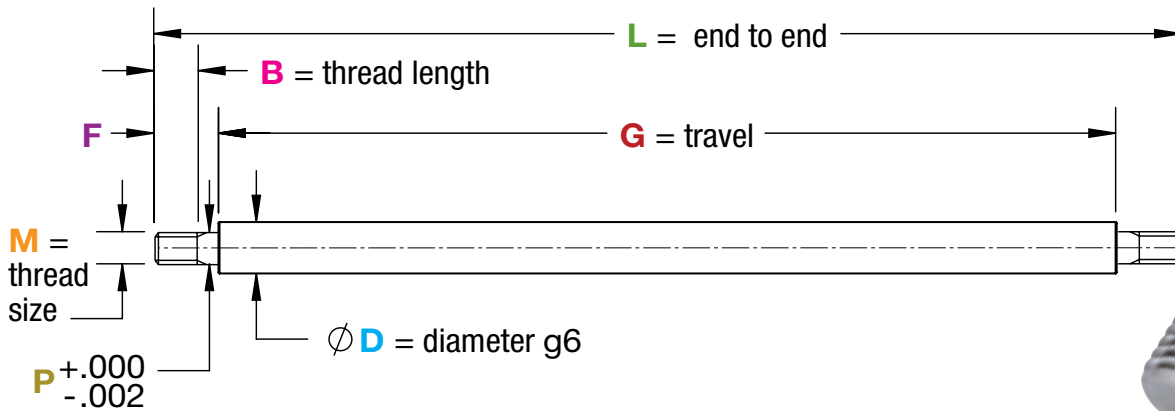

(Dimensions in inches)

Shaft Size Code	Dia. (D)	Thread Size (M)	Thread Length (B)	Journal Length (F)	Journal Dia. (P)	4" Travel (G)		6" Travel (G)		8" Travel (G)		12" Travel (G)		24" Travel (G)		36" Travel (G)		48" Travel (G)	
						Overall (L)		Overall (L)		Overall (L)		Overall (L)		Overall (L)		Overall (L)		Overall (L)	
						FS115	FS116	FS115	FS116	FS115	FS116	FS115	FS116	FS115	FS116	FS115	FS116	FS115	FS116
6	3/8	1/4-20	0.31	0.50	0.250	4.500	5.000	6.500	7.000	8.500	9.000	12.500	13.000	24.500	25.000	-	-	-	-
8	1/2	5/16-18	0.39	0.63	0.313	4.625	5.250	6.625	7.250	8.625	9.250	12.625	13.250	24.625	25.250	-	-	-	-
10	5/8	3/8-16	0.47	0.75	0.375	4.750	5.500	6.750	7.500	8.750	9.500	12.750	13.500	24.750	25.500	-	-	-	-
12	3/4	1/2-13	0.63	1.00	0.500	5.000	6.000	7.000	8.000	9.000	10.000	13.000	14.000	25.000	26.000	-	-	-	-
16	1	5/8-11	0.78	1.25	0.625	-	-	7.250	8.500	9.250	10.500	13.250	14.500	25.250	26.500	37.250	38.500	-	-
20	1 1/4	3/4-10	0.94	1.50	0.750	-	-	7.500	9.000	9.500	11.000	13.500	15.000	25.500	27.000	37.500	39.000	-	-
24	1 1/2	1-8	1.25	2.00	1.000	-	-	-	-	10.000	12.000	14.000	16.000	26.000	28.000	38.000	40.000	50.000	52.000

Format Tapped & Threaded Shaft Tolerances	
Shaft Diameter	Dia. Tolerances
1/4", 3/8"	-0.0002" to -0.0006"
1/2", 5/8"	-0.0002" to -0.0007"
3/4", 1"	-0.0003" to -0.0008"
1 1/4", 1 1/2"	-0.0004" to -0.0010"

Available Materials	
SFW	Carbon Steel
	AISI 52100, 1060 (or equivalent)
	Case hardness is Rockwell C60-C64
SFWS	440C Stainless Steel (or equivalent)
	Case hardness is Rockwell 52-C56

Explanation Of Threaded Shaft (Part Number) Symbols

A	B	x	C	-	D
Series Materials	Shaft Size Code (D)		Overall Length (L)		Shaft Modifications
SFW Carbon Steel					FS115-Single End Threaded FS116-Both Ends Threaded

Stainless Steel sizes are available on this series by quote only

Example:
Carbon Steel slide shaft that has a 1" diameter, is 12" travel with one end threaded. Order **SFW16x13.25-FS115**
Carbon Steel slide shaft that has a 1/2" diameter, is 24" travel with both ends threaded. Order **SFW8x24.25-FS116**

Pre-Cut Slide Shafts



NB Part Number Prefix	Length (inch) (L)	Nominal Diameter (inch)	Diameter Tolerances (inch) From ~ To	Standard Lengths (inch) (L)									
				6	12	18	24	30	36	42	48		
PC	4 - ##	.250	.2498 ~ .2494	◆	◆	◆	◆						
PC	6 - ##	.375	.3748 ~ .3744	◆	◆	◆	◆						
PC	8 - ##	.500	.4998 ~ .4993		◆	◆	◆	◆	◆				
PC	10 - ##	.625	.6248 ~ .6243		◆	◆	◆	◆	◆				
PC	12 - ##	.750	.7497 ~ .7492			◆	◆	◆	◆	◆	◆		◆
PC	16 - ##	1.000	.9997 ~ .9992			◆	◆	◆	◆	◆	◆	◆	◆
PC	20 - ##	1.250	1.2496 ~ 1.2490			◆	◆	◆	◆	◆	◆	◆	◆
PC	24 - ##	1.500	1.4996 ~ 1.4990			◆	◆		◆			◆	◆

Pre-Cut Slide Shaft

Available Material

PC	Carbon Steel
	AISI 52100, 1060 or equivalent
	Case hardness is Rockwell C60-C64

For further details on NB's Linear Shaft, please refer to our General Catalog.

NB CORPORATION OF AMERICA

Hanover Park, IL 60133
 Fax: (630) 295-8881
 1-(800) 521-2045

Fremont, CA 94539
 Fax: (510) 490-1733
 1-(888) 562-4175

Ramsey, NJ 07446
 Fax: (201) 236-5112
 1-(800) 981-8190



<http://www.nbcorporation.com>